

# MFC单相风机调速控制器

MFC Single phase fan speed controller



产品具备欧盟CE认证

- LED指示灯说明操作状态, 在电流没有达到极限的情况下, 可以连接几个电机;
- 输入/输出:90-250VAC(50/60Hz)之间无极变速控制;
- 内置保险丝、浪涌吸收电路、电抗器可以有效防高次谐波干扰
- 插入式安装:IP44;表面安装:IP54;



## 产品用途 Product purpose

该风机调速器是通过改变交流相位导通角的电压, 对应转速电压可控的电机进行手动控制, 实现无级变速控制。适用于插入式安装以及在具有防溅保护的住房进行表面安装, 广泛应用单相异步电机调压调速。

The fan speed controller manually controls the motor with controllable speed and voltage by changing the voltage of the AC phase conduction angle, achieving stepless speed control. Suitable for plug-in installation and surface installation in housing with splash protection, widely used for single-phase asynchronous motor voltage regulation and speed regulation.

## 产品尺寸图 Product dimension diagram

MFC-B型  
长宽高:85.5mm\*85.5mm\*74mm

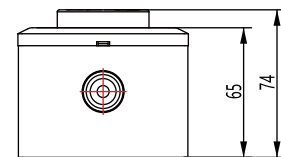
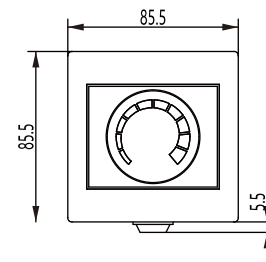

单位 (mm)

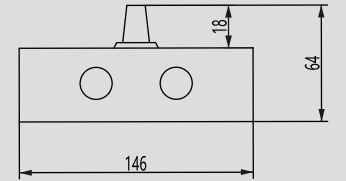
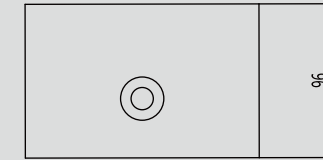
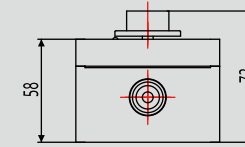
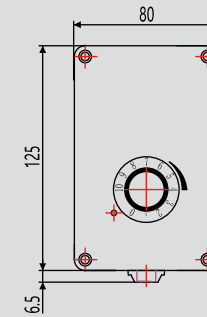

MFC-D型

长宽高:125mm\*80mm\*73mm

MFC-I型

长宽高:146mm\*96mm\*64mm

## 产品接线图 Product wiring diagram

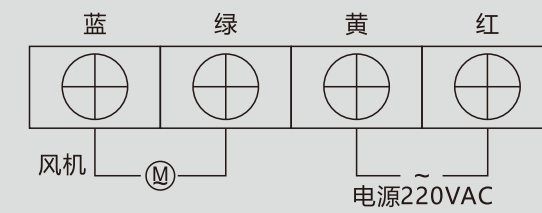

MFC-B型

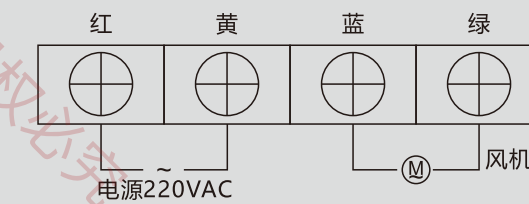

MFC-D型

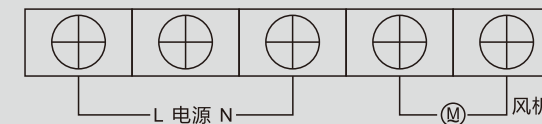

MFC-I型